



C3 V CMM



Features and benefits

With super-light aluminum as a key structural component, and air bearings on all axes, the C3 V bridge CMM is a high performance and cost-effective metrology solution. Due to its size, high capacity table and comprehensive selection of options, the C3 V bridge CMM family is suitable for a wide range of small to medium size applications.

Key Features

- Full CNC and manual joystick control
- 0.5µm resolution scales
- Protected guideways on all axis
- Passive anti-vibration mounts
- Aluminium Y and Z guideways
- Granite table and X guideway
- Air bearings on all axes

Key Benefits

- High acceleration for low cycle times
- Excellent accuracy and repeatability
- Flexible multi-sensor platform:
touch probes, analog scanning, digital scanning
- Small footprint
- High loading capacity table
- Suitable for a shop floor environment

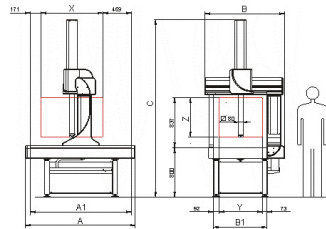

Model H	Strokes (mm)			Overall dimensions (mm)		
Elios Nomos	X	Y	Z	A	B	C
12-9-7	1200	850	700	2070	1495	2795
15-9-7	1500	850	700	2370	1495	2795
18-9-7	1800	850	700	2670	1495	2795
24-9-7	2400	850	700	3270	1495	2795
12-10-9	1200	1000	850	2070	1645	3145
15-10-9	1500	1000	850	2370	1645	3145
18-10-9	1800	1000	850	2670	1645	3145
24-10-9	2400	1000	850	3270	1645	3145
15-10-102	1500	1000	1000	2370	1645	3445
18-10-102	1800	1000	1000	2670	1645	3445
24-10-102	2400	1000	1000	3270	1645	3445

Applications

- Machined and pressed parts
- Plastic moldings
- Casting and forgings
- Touch trigger and non-contact inspection
- Digitizing, scanning and reverse engineering

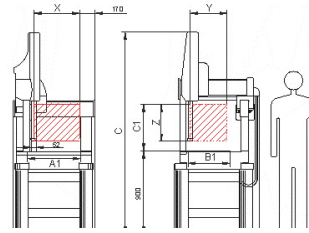

Model E	Strokes (mm)			Overall dimensions (mm)		
	X	Y	Z	A	B	C
5-4-4	500	400	400	920	920	2450

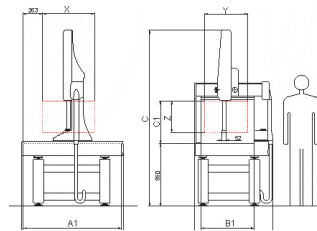

Model A	Strokes (mm)			Overall dimensions (mm)		
	X	Y	Z	A	B	C
7-6-4	700	550	400	1380	1060	2425
10-6-4	1000	550	400	1680	1060	2425
7-7-5	700	650	500	1380	1160	2525
10-7-5	1000	650	500	1680	1160	2525
12-7-5	1200	650	500	1880	1160	2525
14-7-5	1400	650	500	2080	1160	2525



NIKON CORPORATION
Shin-Yurakucho Bldg., 12-1, Yurakucho 1-chome
Chiyoda-ku, Tokyo 100-8331 Japan
phone: +81 3 3773 9026 fax: +81 3 3773 9062
www.nikon-instruments.jp/eng/

NIKON METROLOGY EUROPE NV
tel. +32 16 74 01 01
sales_europe@nikonmetrology.com
NIKON METROLOGY GMBH
tel. +49 6023 91733-0
sales_germany@nikonmetrology.com
NIKON METROLOGY SARL
tel. +33 1 60 86 09 76
sales_france@nikonmetrology.com

NIKON METROLOGY, INC.
tel. +1 810 2204360
sales_us@nikonmetrology.com
us.nikonmetrology.com
www.nikoninstruments.com
NIKON METROLOGY UK LTD.
tel. +44 1332 811349
sales_uk@nikonmetrology.com

NIKON METROLOGY, INC.
12701 Grand River
Brighton, MI 48116
phone: +1 810-220-4360 fax: +1-810-220-4300
Sales_US@nikonmetrology.com

NIKON INSTRUMENTS (SHANGHAI) CO. LTD.
tel. +86 21 5836 0050
tel. +86 10 5869 2255 (Beijing office)
tel. +86 20 3882 0550 (Guangzhou office)
NIKON SINGAPORE PTE. LTD.
tel. +65 6559 3618
NIKON MALAYSIA SDN. BHD.
tel. +60 3 7809 3609
NIKON INSTRUMENTS KOREA CO. LTD.
tel. +82 2 2186 8400

More products, locations and representatives at www.nikonmetrology.com